



Residential Suggested Parts Guide



1500 Series Softeners

EEC1502 R25:

Resin: 0.70 cu. ft.
Capacity: 26,600 grains
Valve: ¾" SDV

EEC1502 R40:

Resin: 1.08 cu. ft.
Capacity: 39,000 grains
Valve: 1" SDV

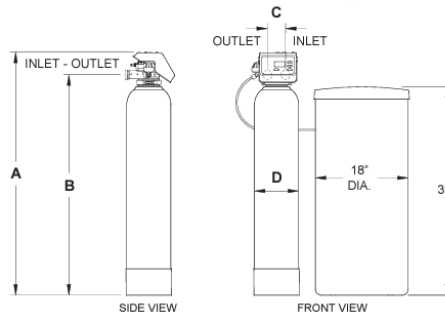

	EEC 1502R25	EEC 1502R40
Nominal Resin Tank Size	8" dia. x 40" tall	9" dia. x 40" tall
A	45-1/2"	47"
B	41-3/8"	41-3/4"
C	3-3/8"	3-3/4"
D	8-1/4" dia.	9-1/4" dia.

Parts Not Included:

Overflow Hose Clamp: 7331258 (kit)

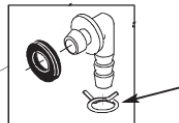

Shroud: 7346724 (kit)

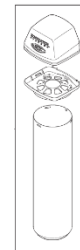

Bypass Valve Assembly, ¾": 7278434

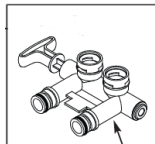

Bypass Valve Assembly, 1": 7214383

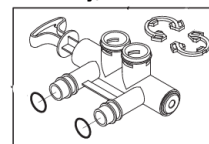

Suggested Service Parts (keep on-hand):

Clip, 1", Pack of 20: 7336428
Clip, ¾", Pack of 20: 7336397



Installation Adaptor, 1", pack of 10: 7336614
Installation Adaptor, ¾", Pack of 10: 7336606

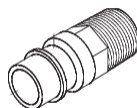

Nozzle & Venturi Kit, 1": 7398705
Nozzle & Venturi Kit, ¾": 7398674

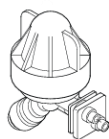

Bypass O-ring, ¾", Pack of 20: 7336410
Bypass O-ring, 1", Pack of 20: 7336402



Wire Harness, Sensor, 1": 7309811
Wire Harness, Sensor, ¾": 7309803

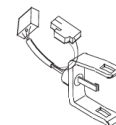

Distributor O-ring Kit: 7112963

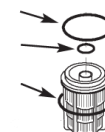

2800 Series Softeners

ESD2800 R25:

Resin: 1.14 cu. ft.

Capacity: 41,200 grains

Valve: 1" SDV

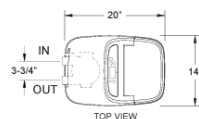

Model	Nominal Resin Tank Size
ESD2800R25	10" dia. x 35"

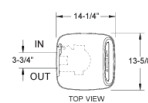

Model	Nominal Resin Tank Size	Dimension A	Dimension B
ESD2802R30	9" dia. x 35"	45"	38-3/16"
ESD2802R39	10" dia. x 47"	57"	49-7/8"

ESD2802 R30:

Resin: 0.82 cu. ft.

Capacity: 26,200 grains

Valve: 1" SDV

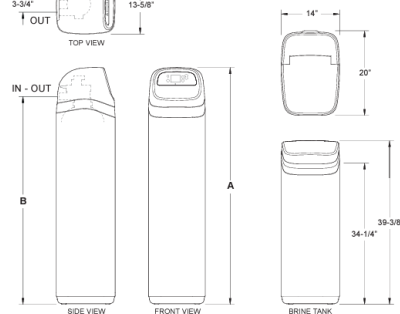
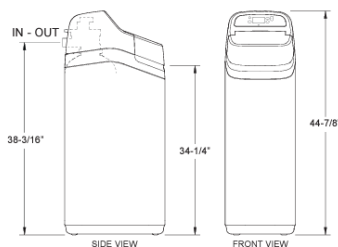

ESD2802 R39:

Resin: 1.13 cu. ft.

Capacity: 40,200 grains

Valve: 1" SDV

Parts Not Included:

Bypass Valve Assembly, 1": 7214383

Plastic Installation Adaptor, 1", (copper inc.): 7271204

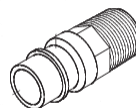
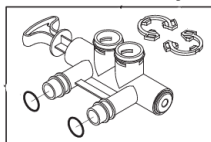

Suggested Service Parts (keep on-hand):

Clip, 1", Pack of 20: 7336428

Bypass O-ring, 3/4", Pack of 20: 7336410



Plastic Installation Adaptor, 1", Pack of 10: 7336614

Wire Harness, Sensor, 1": 7309811

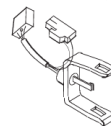
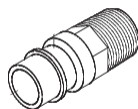

Copper Tube, 1", Pack of 10: 7344138

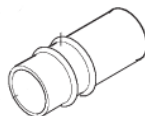

Nozzle & Venturi Kit, 1": 7398705

Distributor O-ring Kit: 7112963

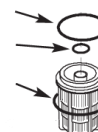
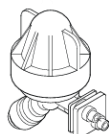

3700 Series Conditioners - Cabinet

ECR3700 R20:

Resin: 0.60 cu. ft.

Capacity: 18,400 grains

Valve: 1" DDV

ECR3700 R30:

Resin: 0.89 cu. ft.

Capacity: 27,100 grains

Valve: 1" DDV

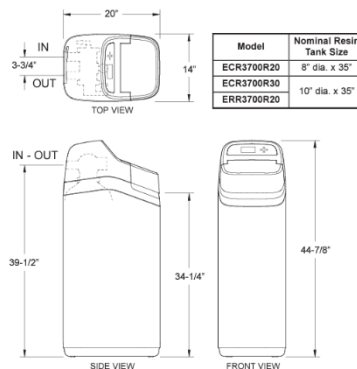

Parts Not Included:

Bypass Valve Assembly, 1": 7214383

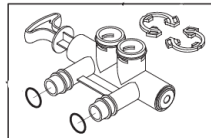

Plastic Installation Adaptor, 1", (copper inc.): 7271204

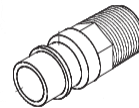

Overflow Hose Clamp: 7331258 (kit)

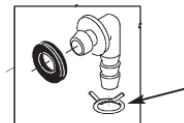

Suggested Service Parts (keep on-hand):

Clip, 1", Pack of 20: 7336428



Bypass O-ring, 3/4", Pack of 20: 7336410



Plastic Installation Adaptor, 1", Pack of 10: 7336614

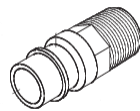

Wire Harness, Sensor, 1": 7309811

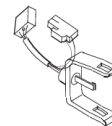

Copper Tube 1", Pack of 10: 7344138

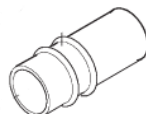

Copper Tube, 1 1/4": 7234555



Nozzle & Venturi Kit, R20: 7398705

Nozzle & Venturi Kit, R30: 7398690

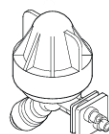

Distributor O-ring Kit: 7112963

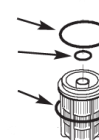

3700 Series Conditioners – 2 Tank

ECR3702 R30:

Resin: 0.89 cu. ft.
Capacity: 27,100 grains
Valve: 1" DDV

ECR3702 R40:

Resin: 1.18 cu. ft.
Capacity: 36,300 grains
Valve: 1" DDV

ECR3702 R50S:

Resin: 1.53 cu. ft.
Capacity: 50,000 grains
Valve: 1" DDV

ECR3702 R70:

Resin: 2.05 cu. ft.
Capacity: 71,500 grains
Valve: 1" DDV

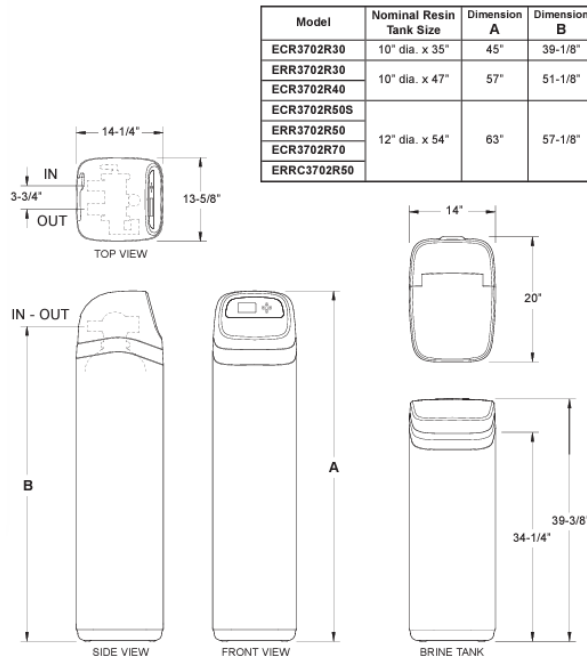

Parts Not Included:

Bypass Valve Assembly, 1": 7214383

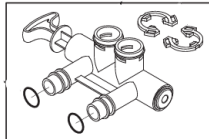

Plastic Installation Adaptor, 1", (copper inc.): 7271204

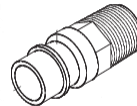

Suggested Service Parts (keep on-hand):

Clip, 1", Pack of 20: 7336428



Bypass O-ring, 3/4", Pack of 20: 7336410



Plastic Installation Adaptor, 1", Pack of 10: 7336614



Wire Harness, Sensor, 1": 7309811



Copper Tube 1", Pack of 10: 7344138

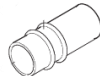

Copper Tube, 1 1/4": 7234555



Nozzle & Venturi Kit, R50 & R70: 7398721

Nozzle & Venturi Kit, R30 & R40: 7398690

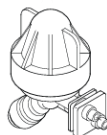

Distributor O-ring Kit: 7112963

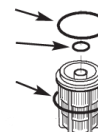

3700 Series Refiners

ERR3700 R20:

Resin: 0.71 cu. ft. ***Contains Activated Carbon**
Capacity: 20,000 grains
Valve: 1" DDV

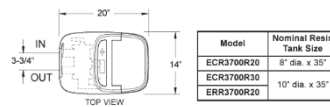

ERR3702 R30:

Resin: 0.88 cu. ft. ***Contains Activated Carbon**
Capacity: 27,100 grains
Valve: 1" DDV

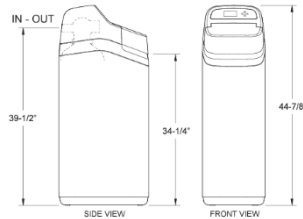

Model	Nominal Resin Tank Size	Dimension A	Dimension B
ECR3702R30	10" dia. x 35"	45"	39-1/8"
ERR3702R30	10" dia. x 47"	57"	51-1/8"
ECR3702R40	12" dia. x 54"	63"	57-1/8"
ECR3702R50	12" dia. x 54"	63"	57-1/8"
ERR3702R50	12" dia. x 54"	63"	57-1/8"

ERR3702 R50:

Resin: 1.56 cu. ft. ***Contains Activated Carbon**
Capacity: 49,900 grains
Valve: 1" DDV

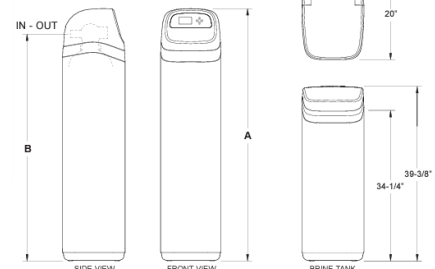
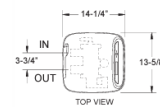

ERRC3702 R50:

Resin: 1.53 cu. ft. ***Contains Catalytic Carbon**
Capacity: 50,000 grains
Valve: 1" DDV

Parts Not Included:

Bypass Valve Assembly, 1": 7214383

Plastic Installation Adaptor, 1", (copper inc.): 7271204

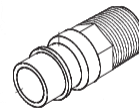
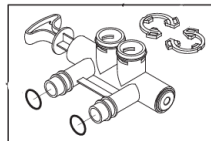

Suggested Service Parts (keep on-hand):

Clip, 1", Pack of 20: 7336428



Bypass O-ring, 3/4", Pack of 20: 7336410



Plastic Installation Adaptor, 1", Pack of 10: 7336614



Wire Harness, Sensor, 1": 7309811



Copper Tube 1", Pack of 10: 7344138

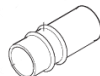

Copper Tube, 1 1/4": 7234555



Nozzle & Venturi Kit, R50 & R70: 7398721

Nozzle & Venturi Kit, R20, R30 & R40: 7398690

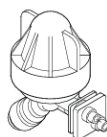

Distributor O-ring Kit: 7112963

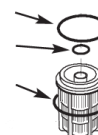

ERO-175 Reverse Osmosis

ERO-175:

Efficiency: 8.94%
Recovery: 20.35%
Storage Tank: 3 Gal

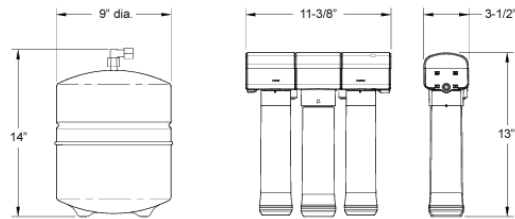

Parts Not Included:

Water Supply Fitting, 1/4" QC: 119-8600084

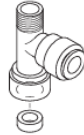

Drain Adaptor: 119-8600123

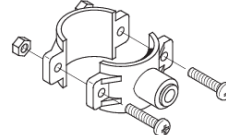

Drain Clamp: 7079791

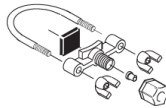

Sanitation Kit: 7301203

Tubing, 1/4" x 20', White: 7161823

Tubing, 3/8" x 20', White: 7157280

Suggested Service Parts (keep on-hand):

Diaphragm Kit: 7333179



Flow Control Insert: 7275185



Pre/Post Filter Cartridge, CTO: 7308263`

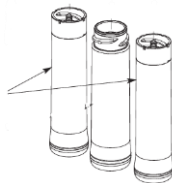

RO Membrane Cartridge, 42 gpd: 7308297

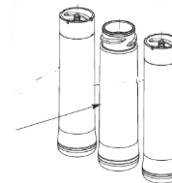

ERO-385 Reverse Osmosis

ERO-385:

Efficiency: 26.2%

Recovery: 41.8%

Storage Tank: 4 Gal

ETF2300PF10:

Parts Not Included:

Water Supply Fitting, 1/4" QC: 119-8600084

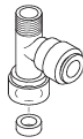

Drain Clamp: 7079791

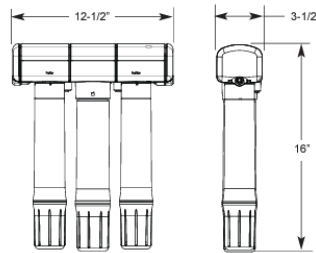
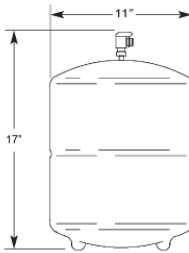
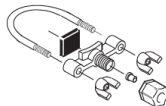

Drain Adaptor: 119-8600123

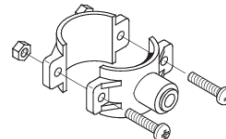

Sanitation Kit: 7301203

Tubing, 1/4" x 20', White: 7161823

Tubing, 3/8" x 20', White: 7157280

WIFI DC Power Supply: 7363417

Faucet: Various Options Available

Suggested Service Parts (keep on-hand):

Diaphragm Kit: 7333179

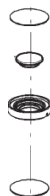

Pre Filter Cartridge, CTO (incl.): 7382916

Pre Filter Cartridge, Sediment: 7273483

Post Filter Cartridge, CTO/VOC: 7382762

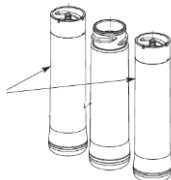

Flow Control Insert, Standard: 7199486

Flow Control Insert, High Recovery: 7395634



Memb. High Recovery, 50 gpd 6 pack: 7397301

Memb. 75 gpd 6 pack (not incl.): 7273264

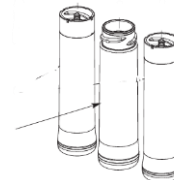

Additional Resources

Softener Sizing:

Step 1: Multiply the number of people in your household by 80. The average person uses about 80 gallons of water a day.

Example: 4 people x 80 gallons = **320 gallons used per day**

Step 2: Test your water for hardness (gpg) and iron (ppm). For each ppm of Iron, add 5 to the hardness number to compensate for that iron. Then, multiply that total by the Gallons Used per Day:

Example: 320 gallons p/day x 18 gpg + 1 ppm iron (5) = **7,360 grains of hardness used daily**

Step 3: These units will recharge or clean themselves about every 5 days on average. We want to make sure to get a large enough unit to cover your daily capacity for at least 5 days. Multiply the Daily Grains of Hardness Used by 5 days.

Example: 7,360 grains daily x 5 days = **36,800 grain capacity min.**

Residential Product Matrix:

<https://ecowater.zendesk.com/hc/en-us/articles/14789244780183-Residential-Product-Matrix>

